

SenSafe® Iodine Test Strips Instructions for Use

DentaPure® Cartridge Models:
DP365B, DP40B AND DP365M

Note:

These tests strips are only to be used to determine the level of IODINE present in Dental Unit Waterlines (DUWLs), and cannot be used to measure the presence of Colony Forming Units (CFU's). Crosstex recommends checking the iodine level at 11 months, or as you approach 240L of water, to ensure that the iodine output has not fallen below 0.5ppm – particularly if you have a very busy practice.



Testing Strip Procedure:

1. Perform a 2-minute flush of all dental unit lines
2. Remove syringe tip from air water syringe
3. Remove one test strip from bottle and reseal bottle to maintain freshness of other test strips
4. Take a 20mL water sample by **tilting the cup and allowing the water to run continuously down the interior side of the cup** to avoid turbulence of the water (using a plastic dental cup is fine)

Taking a 20mL Water Sample

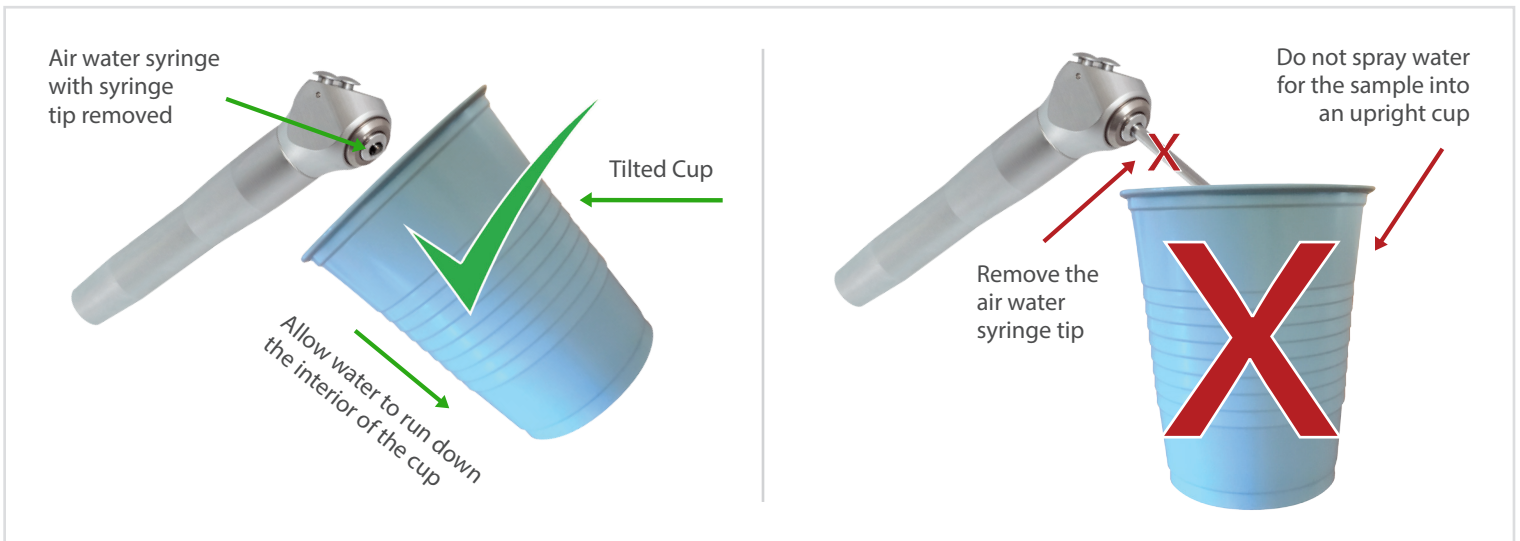



5. Follow instructions for **Method A** as noted on the test strip bottle:

- a. Dip one test strip for 10 seconds in the water sample using a constant, gentle back-and-forth motion
- b. Remove the strip from the water and wait 30 seconds
- c. Match color appearing in the small window of the test strip with the associated Method A color chart with PPM levels from **0.0PPM -5.0PPM**.
 - i. For better color matching, fold the dipped strip in half, so that the window side of strip is facing out (see image)

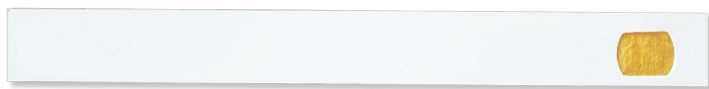

Unfolded Strip



Folded strip with window facing out

Iodine PPM level results and impact on the DentaPure® cartridge:

- If the Iodine Parts Per Million (ppm) reads below 0.5, contact your distributor. The cartridge needs to be replaced
- If Iodine PPM reads above 0.5, continue normal use for another week and then re-check levels

Common Errors:

- Not flushing the system may show a false negative (iodine levels below 1.0)
- Spraying water directly down into the cup without tilting it may cause iodine to dissipate resulting in a false negative (iodine levels below 1.0)
- Matching color from the back of the test strip instead of the window may give you an unclear color match
- Failure to reseal the bottle will cause test strips to lose accuracy over time



This is the back of the strip.
Do not match color from this side.



This is the front of the strip.
Note that the window is visible.
This is the correct side to look for a color match.

QUESTIONS OR COMMENTS?

Visit our website at www.crosstex.com, email: dentapuretechnical@crosstex.com