

Attaching the Adaptor

- 1 On your Porter Brown scavenging system, remove the existing nasal hood by detaching it from both of the circuit's gray "side tubes" (the rigid plastic connectors stay attached to the side tubes).
- 2 Invert the Porter Brown's joined side tubes so the smaller tubes are below the larger tubes, allowing the circuit and nasal hood to fit the patient's face more comfortably.
- 3 Connect the gray Porter Brown side tubes to your new adaptor tubing, making certain that the small tubes of both circuits are on the bottom. For your convenience, your new adaptor has a fresh PIP+™ Nasal Hood already connected to it.

The Accutron adaptor is a system converter and should now remain permanently attached to the Porter Brown circuit.

Changing Nasal Hood for New Patient

- 1 Where the side tubes connect to the small arms of the nasal hood, detach the used nasal hood from the white side tubes (hard plastic connectors stay with side tubes).
- 2 Keeping the scavenging hub connected to its tubing, pull hub with tubing from the used hood's exhalation valve. Discard used nasal hood.
- 3 To attach a fresh PIP+™ Nasal Hood, place 2 fingers inside the top of the hood and push the scavenging hub apparatus (hub with tubing attached) into the nasal hood's exhalation valve. Attach the side tubes to the arms of the fresh nasal hood.

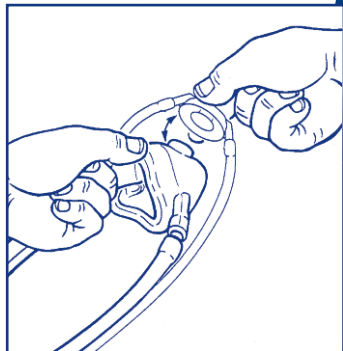
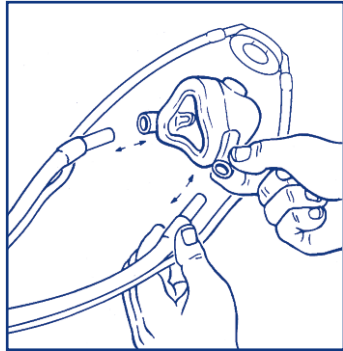
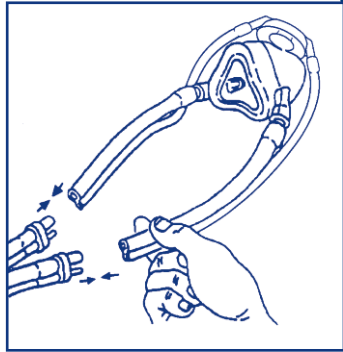
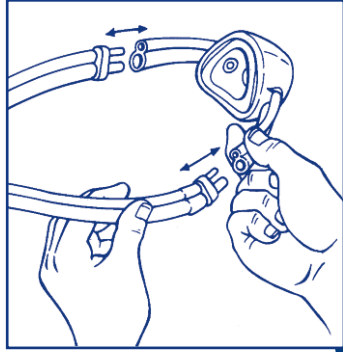

PIP+™ Adaptor #35000 for Porter Brown Scavenging System



1733 W. Parkside Lane • Phoenix, AZ 85027
800-531-2221 • 623-780-2020 • Fax: 623-780-0444
www.accutron-inc.com

